

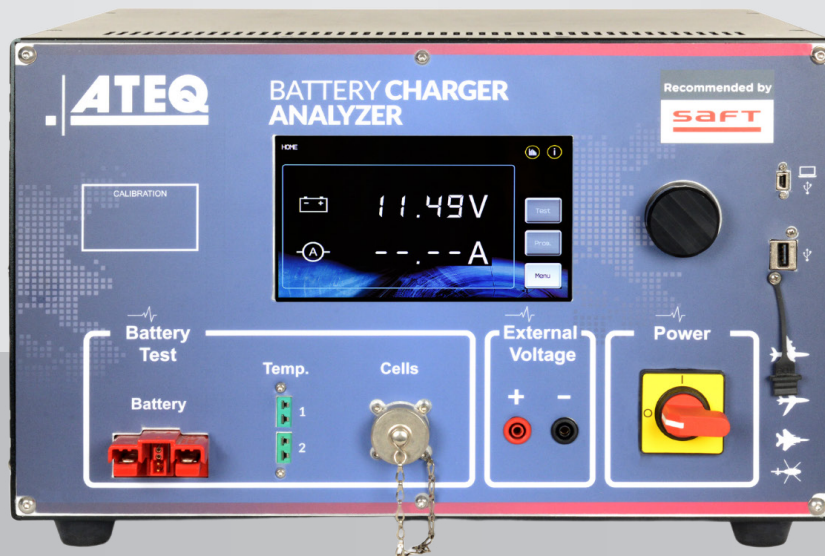

- **ATEQ BCA**
- **Battery Charger Analyser**
(75 V - 40 Amps or 48 V - 60 Amps versions)

Recommended by

saft



- ➔ USER FRIENDLY INTERFACE
- ➔ 1 UNIT FOR 2 BATTERIES (only for BCA 75 V - 40 Amps)
- ➔ External Voltage measurement
- ➔ Up to 24 cells monitoring
- ➔ Computer Management System available

MCMS SOFTWARE FEATURES

FUNCTION	CHARACTERISTICS
Charging phase	<ul style="list-style-type: none"> - Constant or variable Intensity/Voltage - Adjustable from PC, profile, EXCEL file - On I constant, or variable, limit U max, -ΔV, time, temperature min and max, ΔT°/Δt - On U constant, or variable, limit I min, times ΔI (%), temperature min and max, ΔT°/Δt - Temp. protection probe type K, adjustable - Elements voltage measurements and stop or stand by on elements voltage
Discharging phase	<ul style="list-style-type: none"> - Constant or variable Intensity - Adjustable from PC, profile, EXCEL file - U min limit, time, temp. min and max, ΔT°/Δt - Temp. protection probe type K, adjustable - Elements voltage measurements and stop or stand by on elements voltage - Automatic deep discharge
Stand by phase	<ul style="list-style-type: none"> - Stand by period adjustable from PC
Cycle	<ul style="list-style-type: none"> - Choice of phases totally adjustable from PC - In chronological order or according to conditions - Repeat cycles - Sequence of cycles with different phases
Status of channels	<ul style="list-style-type: none"> - Permanent display of battery status, colour code
Status of test	<ul style="list-style-type: none"> - Permanent display of data regarding current phase
Errors message and observations	<ul style="list-style-type: none"> - Error message display - Automatic storage of all errors during test - Send by email: errors, observations, message
Blank play	<ul style="list-style-type: none"> - Check up of all contacts before test lanch
Pause, Stop	<ul style="list-style-type: none"> - Possibility to pause/stop during the test
Delayed or immediate start	<ul style="list-style-type: none"> - Select time and date for test start
Results	<ul style="list-style-type: none"> - Data on test performed and tested battery - Plan voltage, intensity, temperature - Restored or absorbed capacity (% and Ah) - Voltage, Intesity and temperature at the beginning and at the end of phase - Events happened during the selected phase - Voltage of each battery elements - Average, Min and Max of element voltage
Phase filing	<ul style="list-style-type: none"> - Automatic filing at the end of each phase (all data, history traceability) - Save current data if error encountered - Archives in network - Consultation of archives between different benches
Print	<ul style="list-style-type: none"> - Automatic print of results at the end of test - Print on demand of the result of one battery for one phase (modification of axes available) - Possibility to print voltage acquisitions
Display	<ul style="list-style-type: none"> - Display of I, U, T° for each channel in test - Display zoom on curves - Display of each channel in test results - Display of elements tension
Intermittent	<ul style="list-style-type: none"> - Choice of step between prints in automatic mode printing
Inverter	<ul style="list-style-type: none"> - Protection and saving of all data during power cut
Alarm	<ul style="list-style-type: none"> - Buzzer for check-up level of electrolyte, temperature defect
Element voltage	<ul style="list-style-type: none"> - Individual measurement of each battery element voltage
Export data	<ul style="list-style-type: none"> - To EXCEL

DESCRIPTION

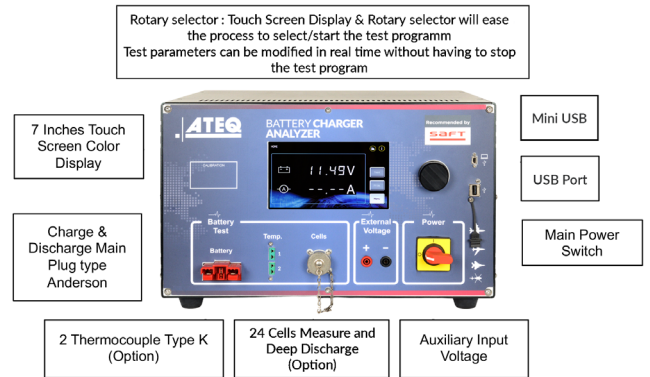

MAIN FEATURES

- 2 Batteries in charge mode (only for BCA version 75 V - 40 Amps)
- Main powers available are indicative ones
- (Voltage and intensity in charge and discharge on each channel can be adapted upon request)
- Immediate or delayed test start
- Control of voltages under 16 bits
- Temperature Measurement with type K thermocouples
- Alarm for electrolyte level
- Shut down at predefined voltages Min, Max or delta V
- Shut down as a function of time - Protection against temperature defect
- Set up of multiple cycles and / or sequences
- Printing and automatic filing of data at the end of the test
- Data protection and results saving and backup in case of power shutdown
- Test result storage and research by user defined criteria
- Curves drawing per phase
- 7 Inch Touch screen color display
- Temperature measurement with thermocouple sensor Type K
- Charge & discharge main plug type Anderson
- 24 cells voltage measurement
- Languages: Chinese, English, French, Russian
- Computer connections: USB port, RS485
- Fuse protection kit

OPTIONAL

Connection systems for battery elements voltage, measurement or deep discharge

ELECTRICAL SPECIFICATIONS

General Electrical characteristics

Sector input:	100-240 VAC Monophased
Frequency:	50-60Hz
Temperature of use:	0-50°C (0-20°C without derating)
Storage temperature:	-20 to +70°C
Cooling:	By forced ventilation
PN EZ-0232 version:	Dimension: 380 x 440 x 265 mm
	Weight: ~26 kg

Power supply characteristics at constant voltage (charging)

Output voltage:	0-75 VDC per channel 0-48 VDC per channel
Regulation:	0.1 % for a variation of I from 10 to 90 %
Stability:	0.1 % at full charge for 8H
Accuracy:	0.1 % reading or +/- 25 mV

Power supply characteristics at constant current (charging)

Output current:	0-40 ADC 0-60 ADC
Regulation:	0.1 % for a variation of U from 10 to 90 %
Stability:	0.1 % at full charge for 8H
Accuracy:	0.2 % reading or +/- 100 mA

Characteristics of the electronic charge (discharging)

Max Power:	1750 W
Absorbed current:	0-60 ADC
Max voltage accepted:	75 VDC 48 VDC
Regulation in constant current:	0.1 % for a variation of U from 10 to 90 %
Stability:	0.1 % at full charge for 8H
Accuracy:	0.2 % reading or +/- 100 mA

Gauge input characteristics

Voltage Measurement

Range	Accuracy
+/- 75 VDC +/- 48 VDC	+/- 0.05 % Max of reading (+-20 mV)

Current Measurement

Range	Accuracy
+ 60 ADC	+/- 0.2 % of reading or +/- 100 mA

Cell voltage - 24 cells (Option)

Range	Accuracy
+/-10 VDC	+/- 0.005 V

Auxiliary Input Voltage (AutoRange)

Range	Accuracy
+/- 75 VDC +/- 48 VDC	+/- 0.05 % Max of Reading or +/- 10 mV

Temperature (Option)

Range	Accuracy
0 to 100 °C (type K thermocouple sensor)	+/- 5°C (apart from sensor)

BCA version 48 Volts / 60 Amps

- 48 Volts max charge and discharge
- 60 Amps max charge and discharge
- Single Battery Charge for 48-60 mode

AVAILABLE ACCESSORIES

- [EC-0326] Rebling © 7007 plug
- [EC-0528] Counter-plug Rebling © 7007
- [EC-0551] Alligator clip kit for battery cell connection (25 pieces)
- [ED-0073] Thermocouple probe type K - 6m
- [EG-0400] External probes for Voltage measurement (Black and Red 4mm²)
- [EG-0701] USB Type A to Mini USB - 1.8m
- [EZ-0191] Deep Discharge Function (No Cable Include)
- [L2-0010] MCMS - Multi Channel Management Software
- [L2-0013] SCSS - Single Channel Setting Software
- [MD-0053] M8 Spacers kit for battery cells connection (25 pieces)
- [MD-0054] M10 Spacers kit for battery cells connection (25 pieces)
- [MD-0055] M12 Spacers kit for battery cells connection (25 pieces)
- [T1-0034] BCA Power output cable - 3.5 m - 2x16mm² + 2x0.5mm² - GRID GPE80 to Eyelet M8
- [T1-0043] Cable RS485 SubD 9 pins Male to female - 1.8m
- [T1-0106] BCA USB to RS485 sub-D9 - cable 5m
- [T1-0132] BCA Power output cable extension- 2m - 2x16mm² + 2x0.5mm² - GRID GPE80 to GRID GPE80
- [T1-0211] BCA Dual connector Battery cable - 2x 16mm² - 2 x 0.5mm² - 2m - GRID GPE80 to REBLING-REBLING ©
- [T1-0217] BCA Cell measurement cable 24 cells - 3.5m - Souriau 26 pin to Banana plugs
- [T1-0268] BCA Cell measurement cable 24 cells - 3.5m - Souriau 26 pin to DB25
- [T1-0309] BCA Power output cable - 2m - 2x16mm² + 2x0.5mm² - GRID GPE80 to Eyelet M8

As a sum up

The BCA is a Battery Charger Analyzer designed to Charge, Discharge and Analyze all types of battery chemistry in the Aviation industry.

It is housed in a metal enclosure with a 7 inch touchscreen control display.

All settings and data can be entered via the touchscreen.

It is a very easy-to-use and versatile instrument that comes in 2 versions the BCA 75 Volts / 40 Amps or the BCA 48 Volts / 60 Amps.

The BCA 75 Volts / 40 Amps can charge two batteries

BCA version 75 Volts / 40 Amps

- 75 Volts max charge and discharge
- 40 Amps max charge
- 60 Amps max discharge
- Charging 2 batteries - 37.5 Volts each max

AVAILABLE ACCESSORIES



[ED-0073] Thermocouple probe type
K - 6m



[MD-0053] M8 Spacers kit for
battery cells connection (25 pieces)



[MD-0054] M10 Spacers kit for
battery cells connection (25 pieces)



[MD-0055] M12 Spacers kit for
battery cells connection (25 pieces)



[EC-0551] Aligator clip kit for
battery cell connection (25 pieces)



[T1-0034] BCA Power output cable
- 3.5 m - 2x16mm² + 2x0.5mm² -
GRID GPE80 to Eyelet M8



[T1-0309] BCA Power output cable
- 2m - 2x16mm² + 2x0.5mm² -
GRID GPE80 to Eyelet M8



[T1-0269] BCA Power output cable
- 5 m - 2x16mm² + 2x0.5mm² -
GRID GPE80 to Eyelet M8



[T1-0132] BCA Power output cable extension-
2m - 2x16mm² + 2x0.5mm² -
GRID GPE80 to GRID GPE80



[T1-0272] BCA Power output cable extension-
5m - 2x16mm² + 2x0.5mm² -
GRID GPE80 to GRID GPE80



[T1-0217] BCA Cell measurement cable
24 cells - 3.5m -
Souriau 26 pin to Banana plugs

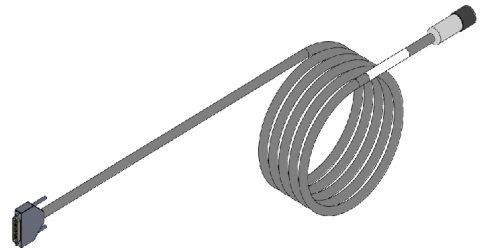

[T1-0268] BCA Cell measurement cable 24
cells - 3.5m -
Souriau 26 pin to DB25



[T1-0375] BCA Cell measurement cable
24 cells - 10m -
Souriau 26 pin to Banana plugs

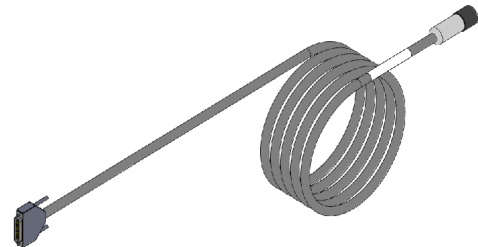

[T1-0376] BCA Cell measurement cable
24 cells - 10m -
Souriau 26 pin to DB25



[EC-0326] Rebling © 7007 plug



[EC-0528] Counter-plug Rebling © 7007
(Counter-plug used in case of charging only
one battery with cable T1-0211)



[T1-0211] BCA Dual connector Battery cable - 2x
 16mm² - 2 x 0.5mm² - 2m -
 GRID GPE80 to REBLING-REBLING (EC-0528
 Counter-plug mandatory in case of charging only one
 battery). Not included



[EG-0400] External probes for Voltage
 measurement (Black and Red 4mm²) - 1.5m



[L2-0010] MCMS - Multi Channel
 Management Software



[L2-0013] SCSS - Single Channel Setting
 Software



[T1-0043_3m] Cable RS485 SubD 9 pins
 Male to female - 3m



[T1-0043] Cable RS485 SubD 9 pins
 Male to female - 1.8m



[T1-0106] BCA USB to RS485
 sub-D9 - cable 5m



[EG-0701] USB Type A to Mini USB - 1.8m

A FULL RANGE OF SERVICES DEDICATED TO YOUR PERFORMANCE

- OUTSTANDING SERVICE
- Global service & calibration support, 2-day calibration
- Multi-brand Calibration Service
- Demo unit rental
- Training
- Maintenance & Repair
- Free loan period
- Multi-brand Calibration Service

➔ More information & Local contact on ateq-aviation.com

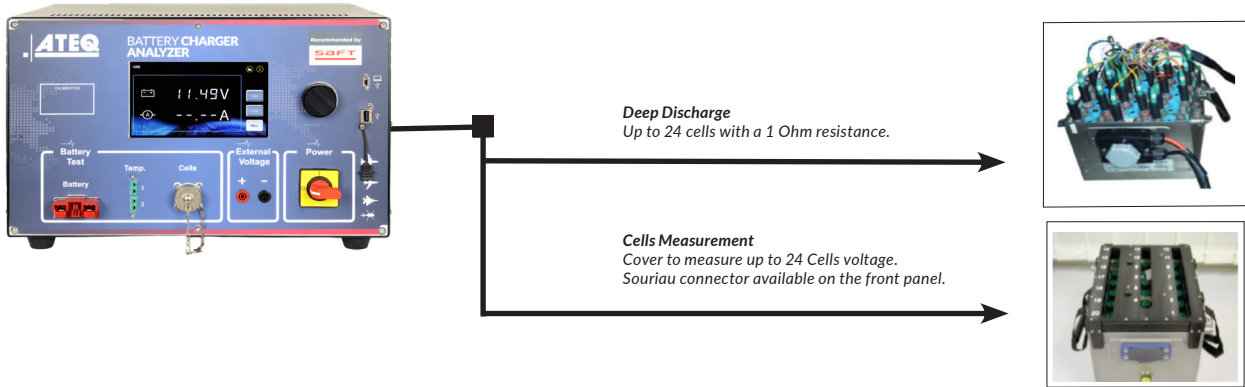
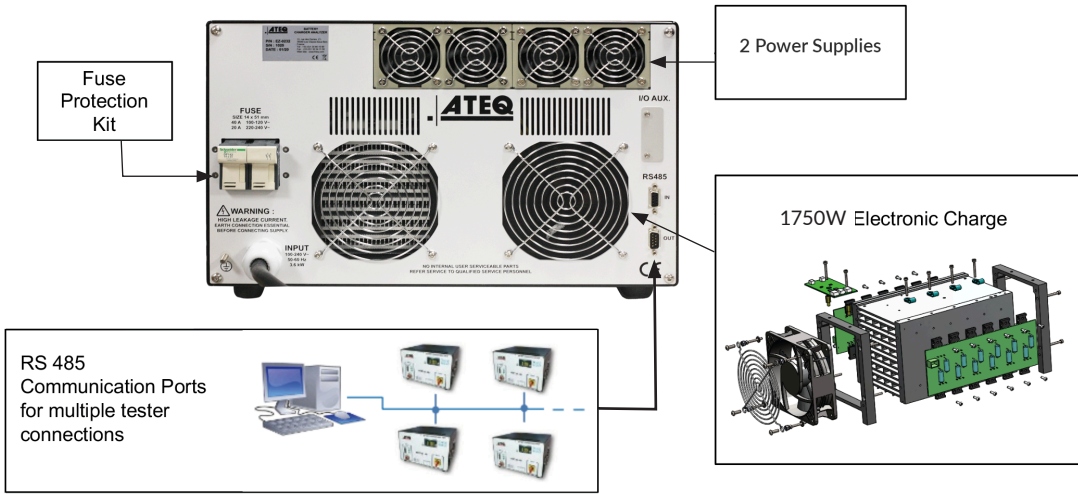

Non-contractual photos. Specifications subject to change without notice. FAC-BCA-A-00430-R00-8-ENG-20240524